

## Frequently Asked Questions

**Q.** Can I use a ready mixed herbicide?

**A.** Yes. Simply pour it into the Weedstick without adding water.

**Q.** When can I use the Weedstick?

**A.** Any time of year when weeds are growing well, usually between Spring and Autumn.

**Q.** What sort of herbicides can I use?

**A.** Contact herbicides give quick results killing the leafy parts but often leaving the roots intact.

Residual or total herbicides also act quickly and may prevent the growth of any vegetation for several months. They are ideal for paths, patios and driveways.

Systemic herbicides act slowly but are absorbed by the leaves and will travel through all parts killing the roots as well as the leaves.

**Q.** How quickly will it work?

**A.** This depends on the type of Herbicide used. Allow up to five weeks for the slower acting herbicides to completely destroy the weed.

**Q.** Should I dig up the weeds?

**A.** No. Allow the herbicide to travel through the visible weed and root system.

**Q.** If I use more herbicide will it work quicker?

**A.** Using a stronger mix may scorch the leaves of the weed which will reduce the amount of herbicide that can be absorbed by the weed. Use the recommended amount.

**Q.** Can I store herbicide in the Weedstick?

**A.** Only if you use a ready mixed herbicide because they contain stabilisers. Herbicides that you dilute with water should be used up or disposed of on a patch of waste ground.

**Q.** I need quick results. Is there a quicker way?

**A.** Use a contact herbicide (for paths and patios). It will work within days and will kill off the leaves that have been treated. Repeat treatments may be required.

W

E

E

D

I

M

# WEEDSTICK

## Instruction Manual



**micron**

Bromyard Industrial Estate, Bromyard,  
Herefordshire, HR7 4HS, UK  
Tel: + 44 (0) 1885 482397  
Fax: + 44 (0) 1885 483043  
E-mail: [micron@micron.co.uk](mailto:micron@micron.co.uk)  
URL: <http://www.micron.co.uk>

## Contents

Description .....	1
Recommendations for use.....	2
Safety .....	3
Filling and Mixing .....	4
Operation .....	4
Cleaning and maintenance .....	5
Disposal of unused Herbicide .....	5
Storage .....	6
Spare parts .....	6
Warranty .....	6
Frequently Asked Questions.....	7

## Description

The hand held Weedstick has been especially developed for the selective application of herbicides and is particularly suitable for selective lawn and garden herbicides.

The Weedstick has significant advantages over conventional methods of application such as knapsack sprayers for spot applications or treating sensitive areas. The herbicide within the Weedstick is applied only to those plants covered by the Weedstick. A small dose of herbicide is transferred precisely and accurately to the target weed with the surrounding plants uncontaminated. The Weedstick is ideal therefore for treatment of weeds in gardens (lawns, patios and paths, flower and vegetable beds, etc.), in row crops, between grape vines, around trees, or any other place where conventional treatment would be too dangerous or difficult.

- No wastage.
- No risk of drift.
- No contamination of the soil.
- Economical.
- Minimal water requirement.

## Storage

Between periods of use, the Weedstick should be stood upright with the funnel uppermost and wrapped in a plastic bag to avoid any problem of contamination. For longer periods of storage unused herbicide should be disposed of and the Weedstick thoroughly washed and cleaned (see 'Cleaning and Maintenance').

## Spare Parts

Should you require any spare parts, please contact us for a list of those parts available.

## Warranty

Your Weedstick is guaranteed for 12 months from the date of purchase against any defect or malfunction caused by faulty parts or workmanship. To claim under the warranty, the Weedstick should be returned at the claimants expense to the manufacturer/distributor with a written explanation of the problem. Should there prove to be a defect caused by faulty parts or workmanship, it will be repaired or replaced and returned to the claimant without charge. If a warranty claim is rejected, the cost of repair or replacement will be notified to the claimant before any work is carried out.

The Warranty is invalid if the Weedstick is modified or deemed, by the manufacturer, to have been damaged by inappropriate use of the Weedstick, or by use not in accordance with the instruction manual.

No liability is accepted for any consequential or indirect loss suffered by the purchasers or users of the equipment whether loss arises from correct or incorrect use of the Weedstick.

After the weed has been treated, only slight traces of herbicide should be visible.

**Do not** walk across freshly treated areas, as herbicide may be transferred by footwear or clothing.

### **Cleaning and Maintenance**

The Weedstick should be thoroughly washed at the end of each week of use, or before storage. Cleaning must also be carried out if the Weedstick becomes covered with plant debris, sap or soil.

**Always** wear gloves when handling the Weedstick.

Empty the Weedstick by pulling out the valve and pouring out the mix into a suitable container to be kept for later use (if already mixed) or to be disposed of. To clean the Weedstick, submerge it in a bucket of clean water and clean with a suitable brush. Alternatively, soak over night.

Rinse the Weedstick after cleaning by filling it with clean water and leaving to soak. It is best not to use a Weedstick for other types of products if it has been used to apply residual herbicides.

All washings should be disposed of properly and safely.

### **Disposal of Unused Herbicide Mix**

The best method of avoiding the need to dispose of unused herbicide mix is to mix a smaller amount than is anticipated to be needed. Then, if required, mix a final small amount to finish the job.

The recommended method for disposal of any unused herbicide is to dilute further and apply it to the already treated weeds or to waste ground where any plants, if present, are not wanted.

### **Recommendations for use**

The Weedstick is recommended for use with herbicides and is particularly suitable for use with selective lawn and garden herbicides. A single shot of the herbicide is enough to kill most weeds up to the size of a fist, a double shot should be used for larger weeds.

General purpose, systemic and residual weedkillers can also be used through the Weedstick. General purpose weedkillers and some systemic weedkillers such as glyphosate kill most plants therefore take great care when using these products in the Weedstick. Generally these products should only be used to treat isolated weeds on bare or hard surfaces, and the Weedstick should be thoroughly cleaned out if such products have been used before using another selective weedkiller. When using glyphosate based herbicides first signs of effect will generally be seen 1 - 2 weeks after treatment. Complete control may take up to 6 weeks.

Tips for use in the garden are:

#### ***Lawn Treatment***

When killing weeds in lawns a contact lawn herbicide may be used. Repeat treatments may be required.

If tough weeds or clumps of coarse grass are a problem use a general purpose herbicide in the Weedstick. The precise dose, just where you need it, will treat the weed without harming a large area of grass.

The Weedstick is ideal for killing weeds in new lawns where it is advisable not to apply an overall treatment.

Do not use a general purpose or systemic herbicide on your lawn except as described above unless you want to kill the grass.

#### ***Patios & Paths***

Use a Path and Patio Weedkiller. Note that using a residual, rather than contact, herbicide can prevent regrowth for several months.

Treat weeds before they have set seed. Otherwise pick off the flowers and seed heads to prevent weed spread.

Caution: It is best not to use a residual herbicide in the Weedstick if you intend using it to treat weeds in borders. Ideally you should use a second Weedstick for this purpose.

### ***Flower Beds***

Treading on weeds will make them easier to treat and will bruise the leaves aiding absorption of herbicide. The Weedstick plunger will also bruise the leaves of the weed.

Treat weeds when they are small. Avoid run off onto leaves of wanted plants.

Very well established weeds in large clumps or dense weed mixtures may need more than one treatment. Re-treatment is usually best made 2 - 3 months after the first application. If previously hidden untreated weeds are seen to be thriving, immediate treatment is advisable.

### **Safety**

**Always** read the label before using any herbicide and follow the safety instructions.

The operator **must** wear suitable protective clothing, such as rubber boots, overalls and protective gloves when using the Weedstick if these are specified in the herbicide label.

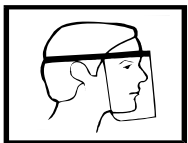
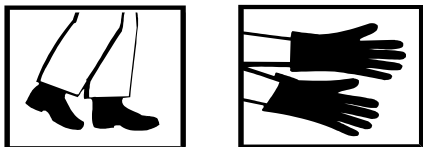

Always wear a face shield when mixing and filling, or handling, undiluted pesticides.

### **Filling and Mixing**

The Weedstick is very economical in the amount of herbicide it uses. A single fill should treat around 75 weeds. If diluting herbicides i.e. not using already mixed herbicides always mix less herbicide than it is anticipated is needed. This will reduce the risk of wastage and the need to dispose of unwanted herbicide if weather conditions change.

An already mixed herbicide can be poured directly into the Weedstick. If mixing up a herbicide with water follow the sequence shown below:

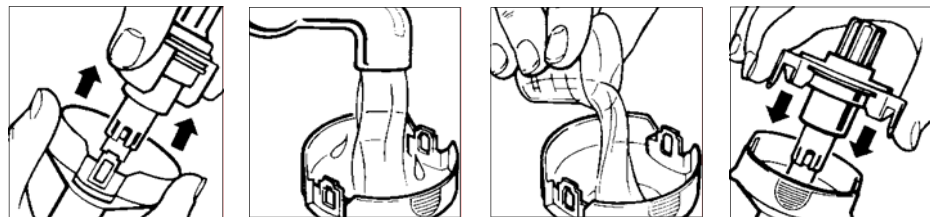

1. Simply squeeze sides of funnel at arrows and pull out valve using red fingergrrips.
2. Pour in water to roughly half fill the tube.
3. Add 2.5 ml of herbicide concentrate using the measure provided.
4. Add more water to top of clear tube then refit the valve.
5. Turn slowly end over end three or four times before use allowing bubbles to rise through the tube with each turn.

In order to help identify treated plants, it can be useful to add a dye e.g. coloured food dye.

### **Operation**

Prod the leafy part of the weed with the funnel end of the Weedstick, being careful not to touch other plants. Press down once for most weeds up to fist size, twice for larger weeds.